

Intro Brushed Stainless 1.2L Liquid Soap Dispenser



Part Number 1200SD-BS

Brushed 304 grade stainless steel with chrome sides
Designed to dispense liquid hand soap
Bulk fill soap dispenser with non-drip valve 1.2L capacity
Robust and hygienic material to clean and maintain
Easy action push button operation
Level window indicator to monitor soap levels
Key lockable with a fixing kit and key provided

The Intro Range is made from 304 grade Stainless Steel

Height 230mm
Width 125mm
Projection 65mm

Dimensions

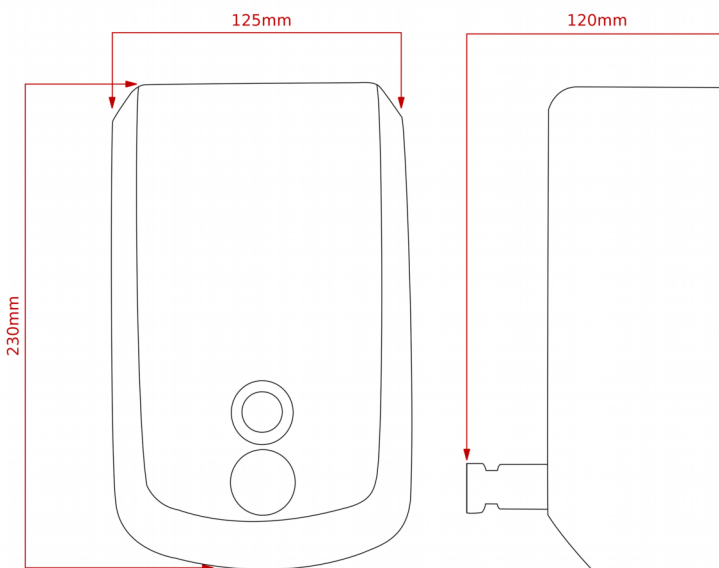

Capacity

LIQUID
PUMP



1.2 L

Flowable liquid soap, gel
1,200ml refillable capacity, direct into the unit

The soap is filled by using the lid which is spring loaded and can only be opened with the key